

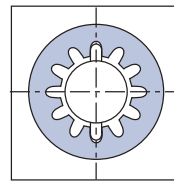

Application Gauging Bore Measurement - Internal Spline

2 and 3 point heads available.
Anvils manufactured from tool steel.
Between pin, major and minor diameter heads available.
Diameters from 8-300mm
diameter (5/16"-12").

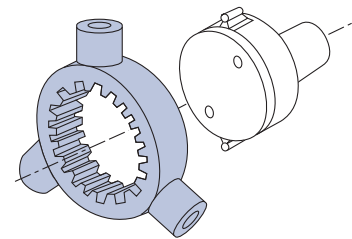

Pitch Diameter

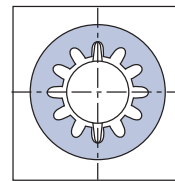

Major Diameter

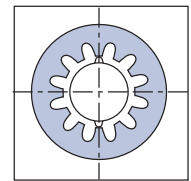

Minor Diameter

Special Measurement - External Spline

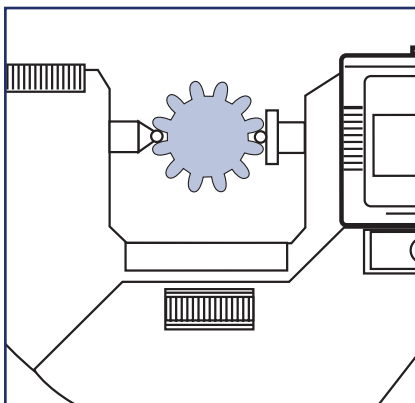

Frames fitted with 1 x ball and 1 x pin

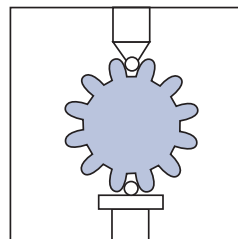

Pitch Diameter

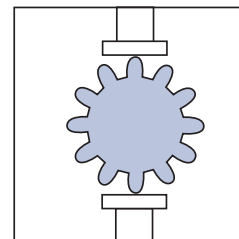

Major Diameter

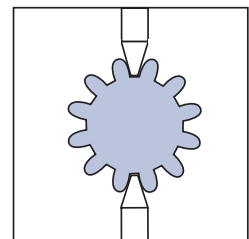

Minor Diameter